

REV	DATE	ECO	DESCRIPTION	BY	CK	APP
A	1/29/07	NA	REDRAWN WAS ON 17518 REV - REMOVED GGX-(1/10-3/8)	DRL	NA	NA

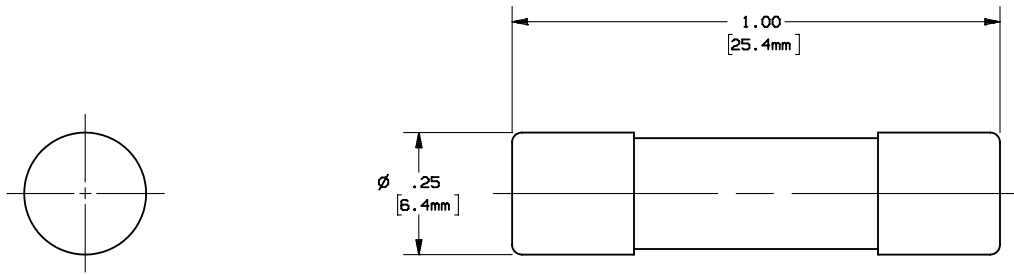

MERSEN USA NEWBURYPORT-MA, LLC
 374 MERRIMAC STREET
 NEWBURYPORT, MA 01950

GGX-
 (1/2, 3/4, 1, 1-1/4, 1-1/2, 2, 3, 4, 5,
 6, 7, 8, 10, 12, 15, 20, 25, 30)

OUTLINE DIMENSIONS
 NOT TO BE USED FOR PRODUCTION

PRODUCT MANAGER
 SIGN:
 DATE:

DESIGN ENGINEER
 SIGN:
 DATE:

1/2-2A 250V
 3-7A 125V
 8-30A 32V

17518