

REV.	DATE	ECO	DESCRIPTION	BY	CK	APP
-	1/4/2011	N/A	INITIAL RELEASE	LDB	N/A	N/A
B	1/25/2024	18032	REDRAWN FROM CADRA, UPDATED TITLE BLOCK, ADDED NOTES, DIM .44[11.2] WAS .50[12.7], 1 LBS FORCE WAS 2 LBS FORCE	YF	N/A	SEE ECO

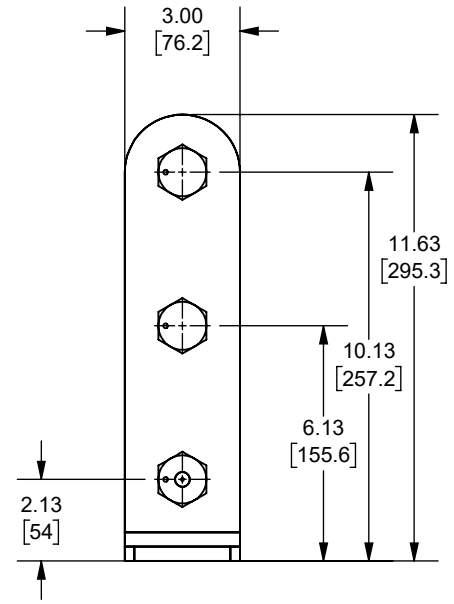
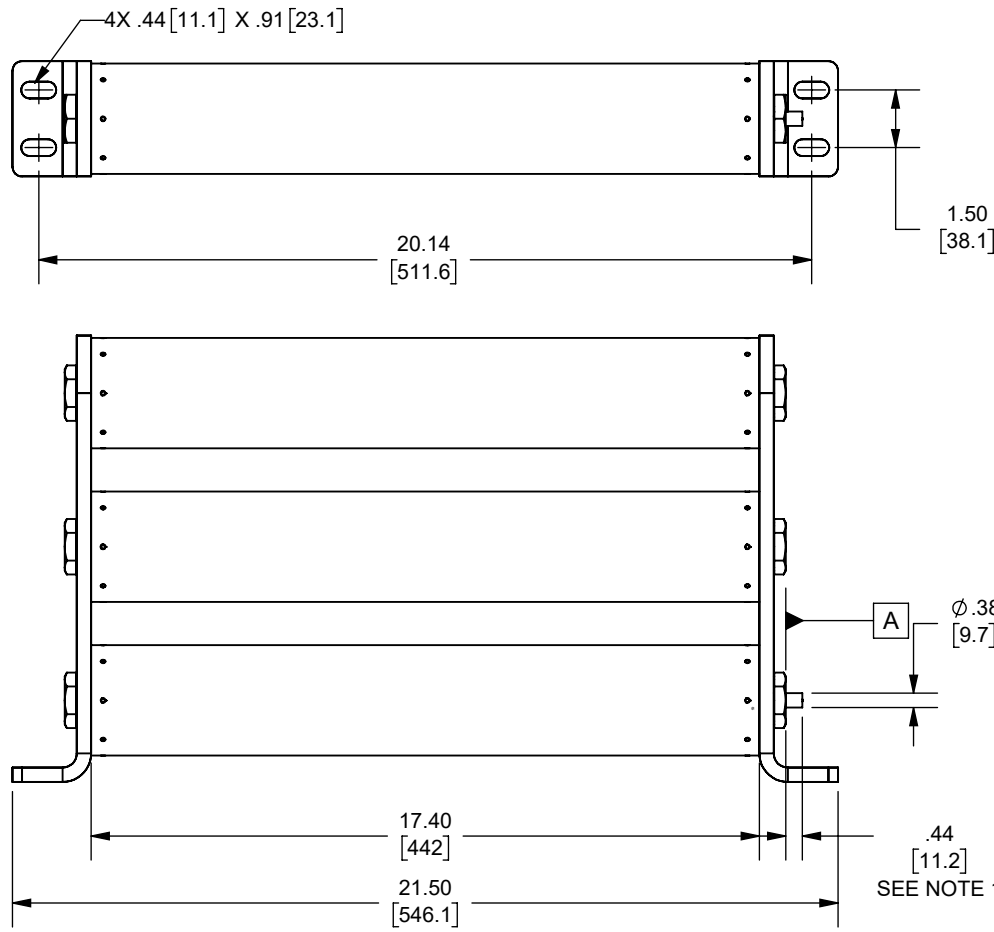

OUTLINE DIMENSIONS
NOT TO BE USED FOR PRODUCTION

DIMENSIONS IN [] ARE MILLIMETERS

NOTES:
1. INDICATOR IS FLUSH WITH SURFACE [A] BEFORE FUSE OPENS INDICATOR EXTENDS .44 IN. [11.2mm] AFTER FUSE OPENS AND EXERTS AN 1 LBF AT THE END OF TRAVEL.

Approval stage / Etat d'approbation: APPROUVÉ POUR FABRICATION / APPROVED FOR MANUFACTURING	Product Class:/ Product Type:	MEDIUM VOLTAGE AMP-TRAP R-RATED BOLT-IN SERIES	
	Product amp rating:/ Voltage rating:	48X - 57X 7.2kV MAX.	
Initial ECO / ECO intiale:	ECO-18032-000	Title / Titre:	Weight / Masse :
Draw by / Dessiné par: Yadyra Fang	Date : 6/14/2024	OUTLINE A072B3DCR0-(48, 57)X	
Checked by / Vérifié par: Luis ARMENTA	Date : 6/14/2024		
Electrical Power 374 MERRIMAC STREET NEWBURYPORT, MA 01950	Éch / Scale : 1:5 Format / Size : A	Drawing / de dessin: 701642	Rev : B Rév :
A072B3DCR0-57X A072B3DCR0-48X CATALOG NUMBER		Part / Article: SEE TABLE	Page : 1/1 MERSEN

Ce plan strictement confidentiel est la propriété exclusive de la société MERSEN sans l'autorisation écrite de laquelle il ne peut être ni reproduit, ni copié, ni communiqué à des tiers.
This drawing and specifications there on is property of MERSEN and shall not be reproduced or copied or used in whole or in part as the base for manufacture or sale of item without written permission.