

| REV | DATE | ECO | DESCRIPTION | BY | CK | APP |
|-----|----------|-----|-----------------|-----|----|-----|
| - | 12-15-03 | NA | INIITAL RELEASE | KMH | NA | NA |

INDICATOR FLUSH WITH SURFACE "A" BEFORE FUSE OPENS.
 INDICATOR EXTENDS .50in. (12.7mm) AFTER FUSE OPENS
 INDICATOR EXERTS 2 lBS FORCE AT END OF TRAVEL

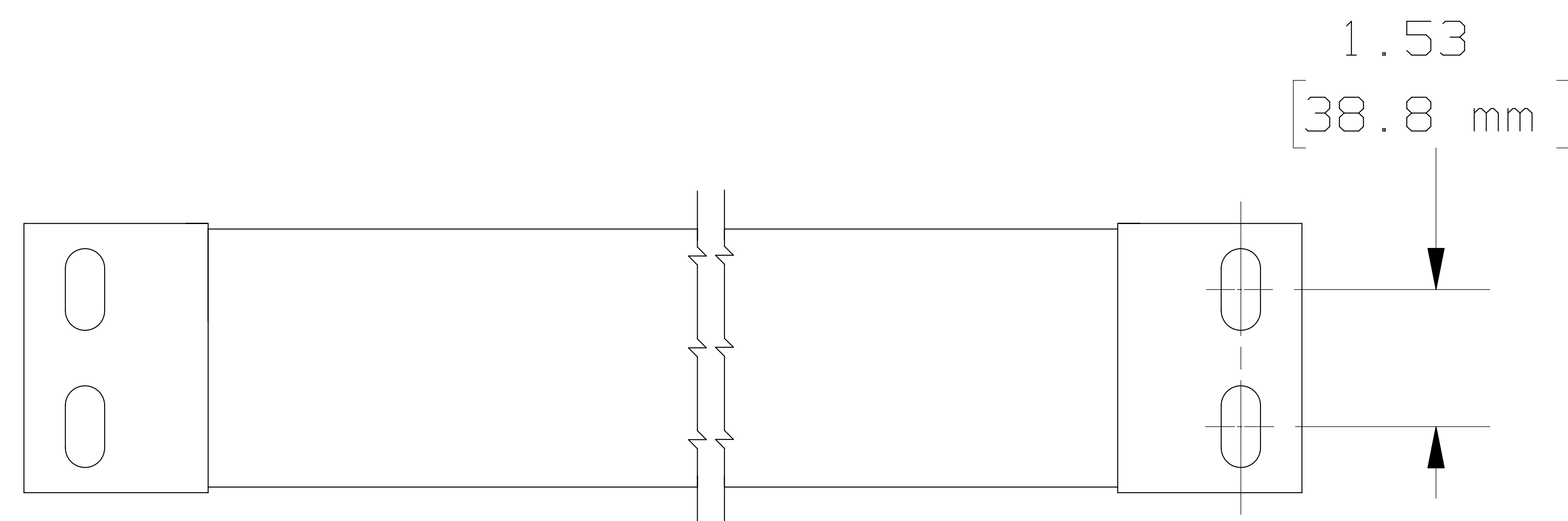

| RATING | CATALOG NO. |
|--------|----------------|
| 19R | A072B1D0R0-19R |

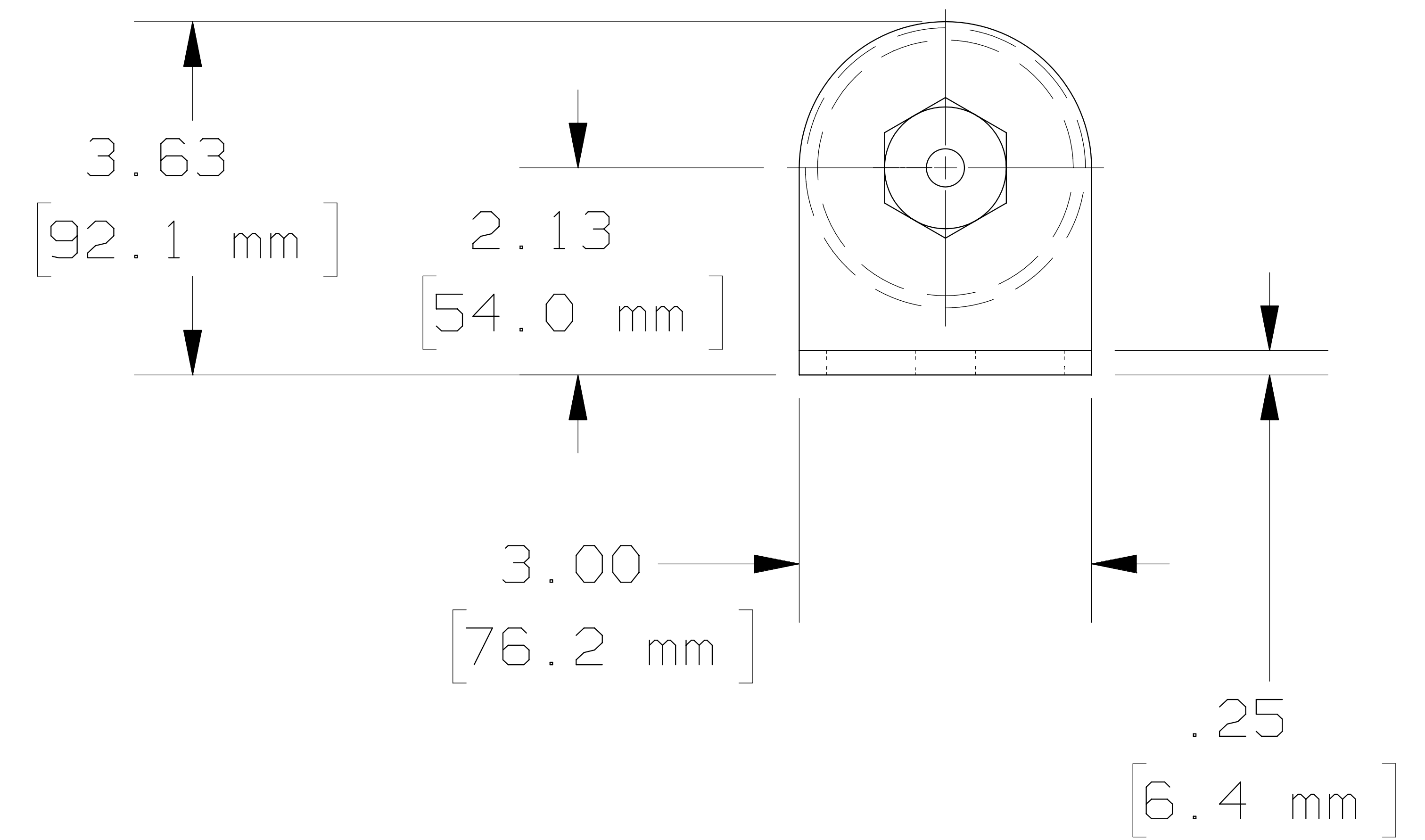
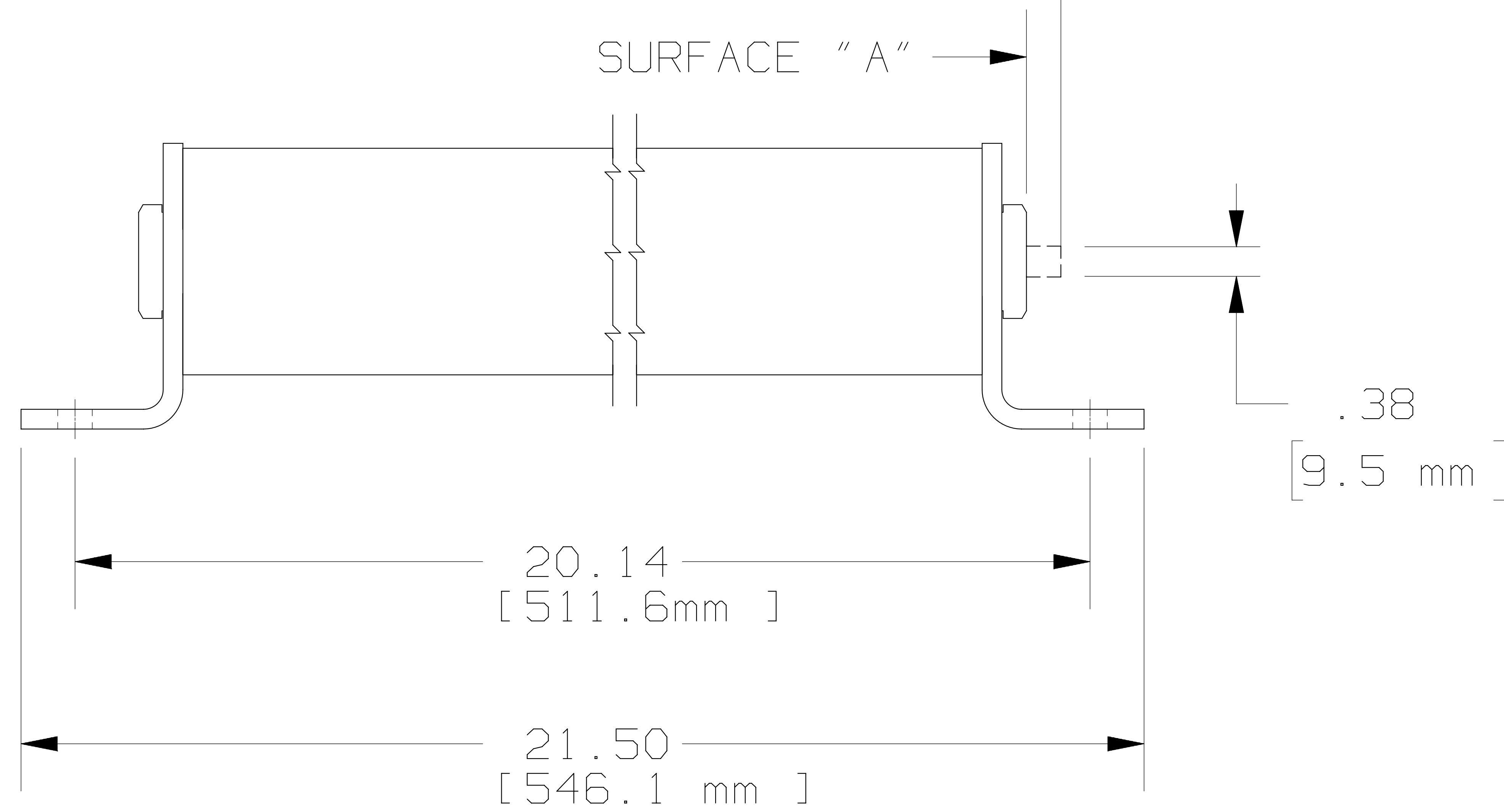

MERSEN USA NEWBURYPORT-MA, LLC
 374 MERRIMAC STREET
 NEWBURYPORT, MA 01950

MEDIUM VOLTAGE AMP-TRAP
 R-RATED MOTOR CIRCUIT BACKUP
 CURRENT LIMITING FUSE
 BOLT-IN SERIES
 19R 7.2kV MAX

OUTLINE DIMENSIONS
 NOT TO BE USED FOR PRODUCTION

701029

PRODUCT MANAGER
 SIGN:
 DATE:

DESIGN ENGINEER
 SIGN:
 DATE: