

REV	DATE	ECO	DESCRIPTION	BY	CK	APP
-	5/21/02	N/A	INITIAL RELEASE	LAS	N/A	N/A

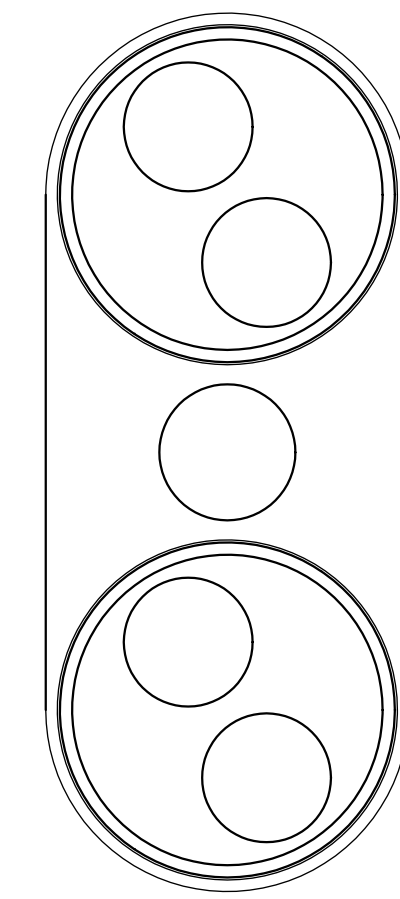

91

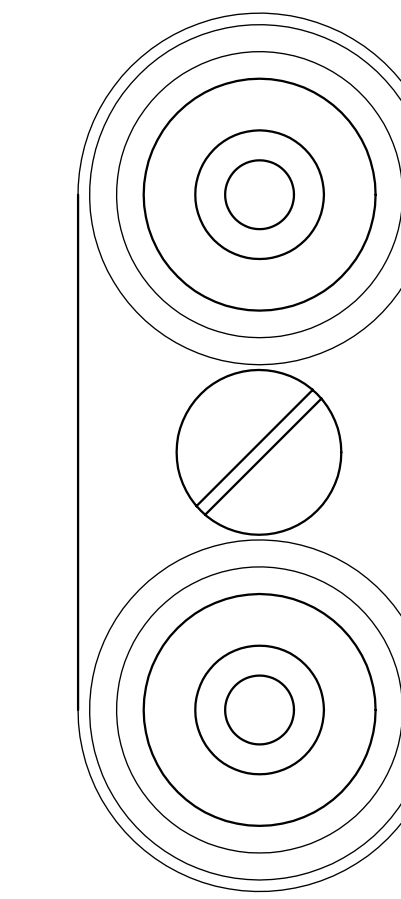
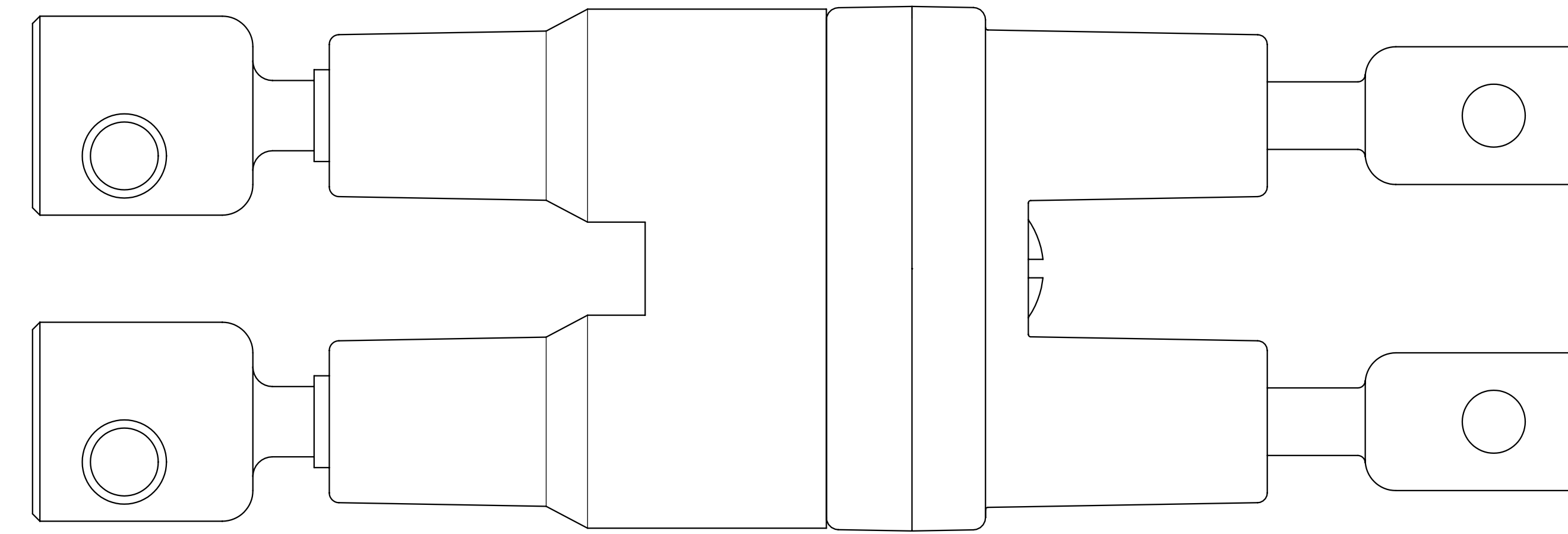

81

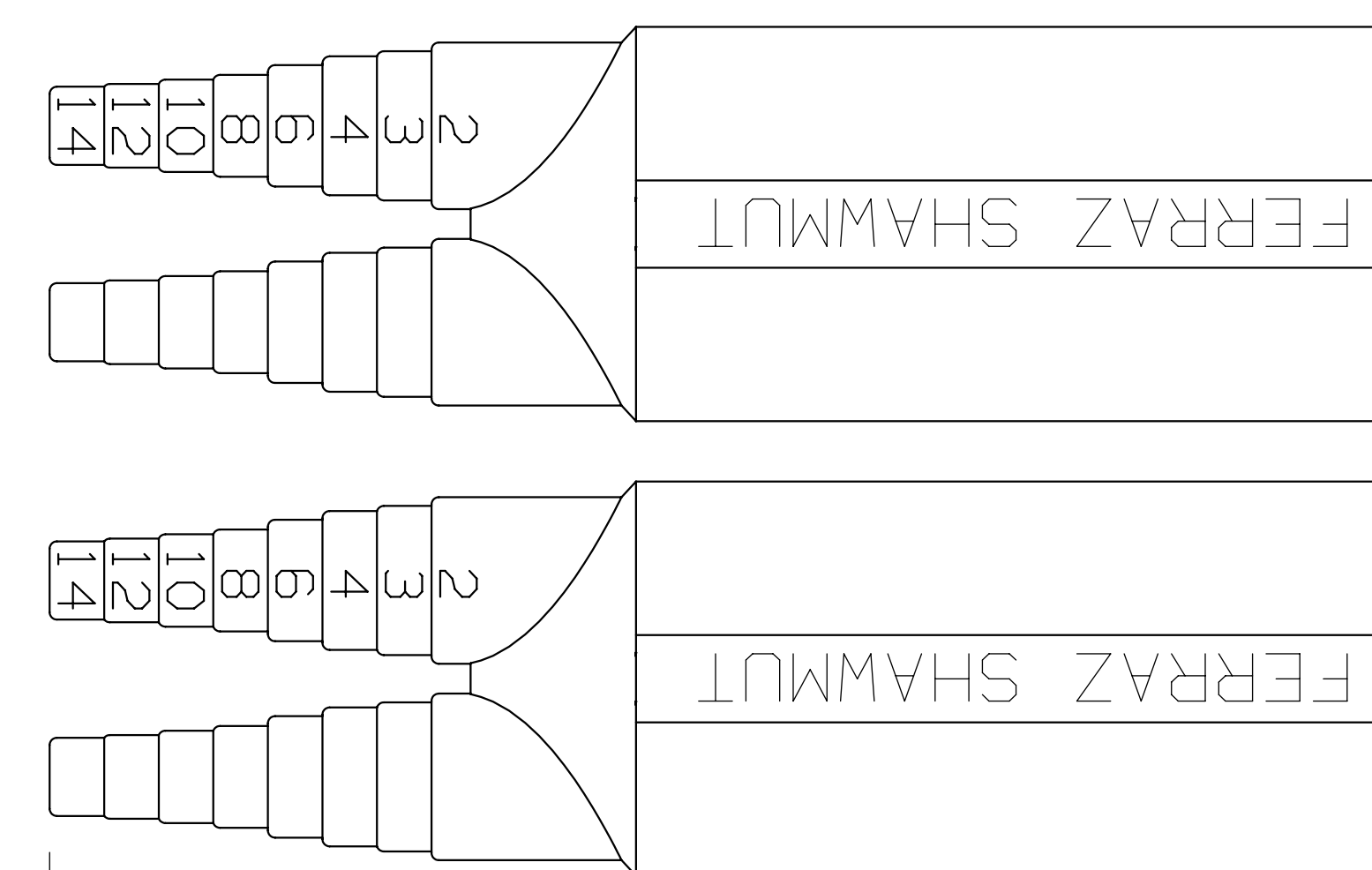

(FSB2 BOOT)

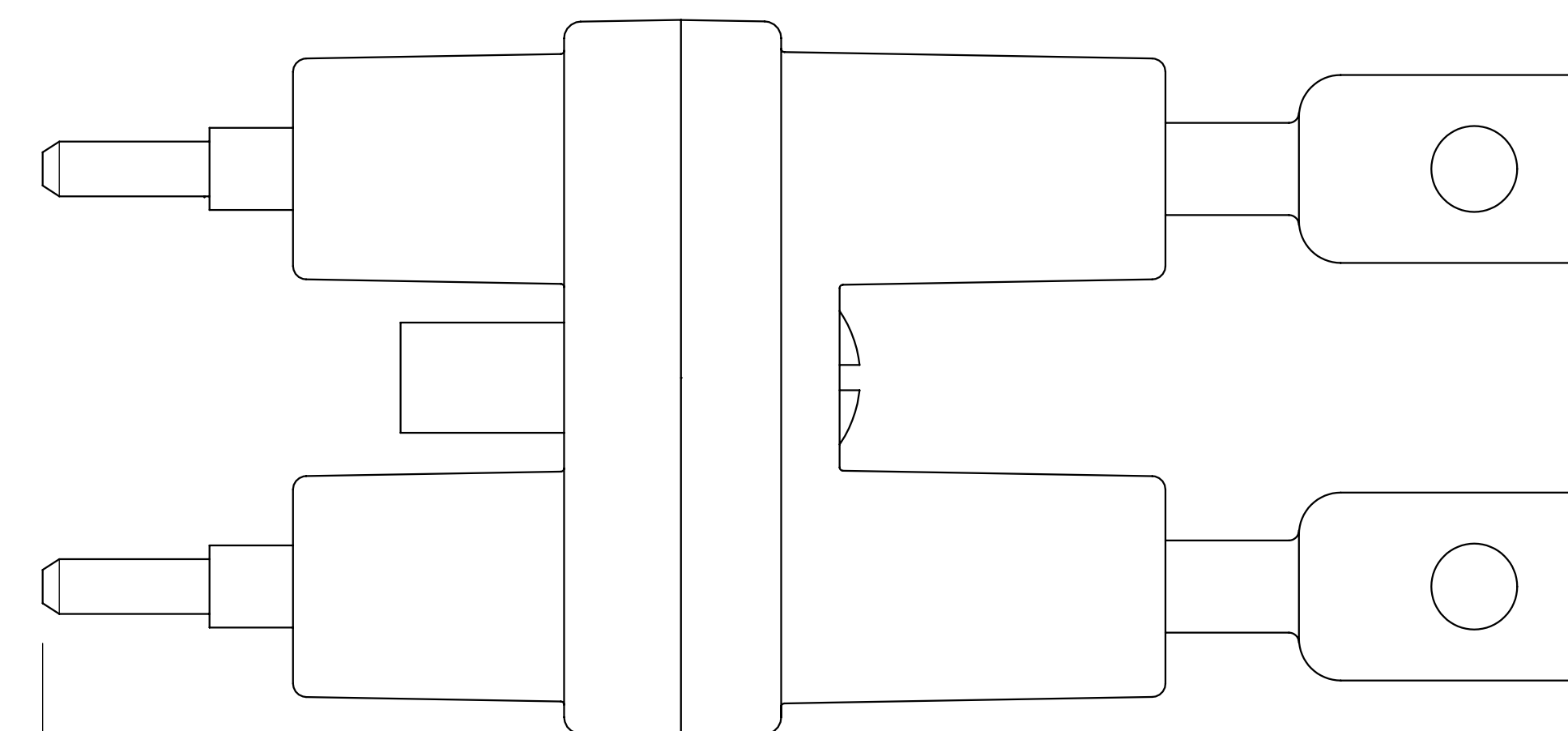
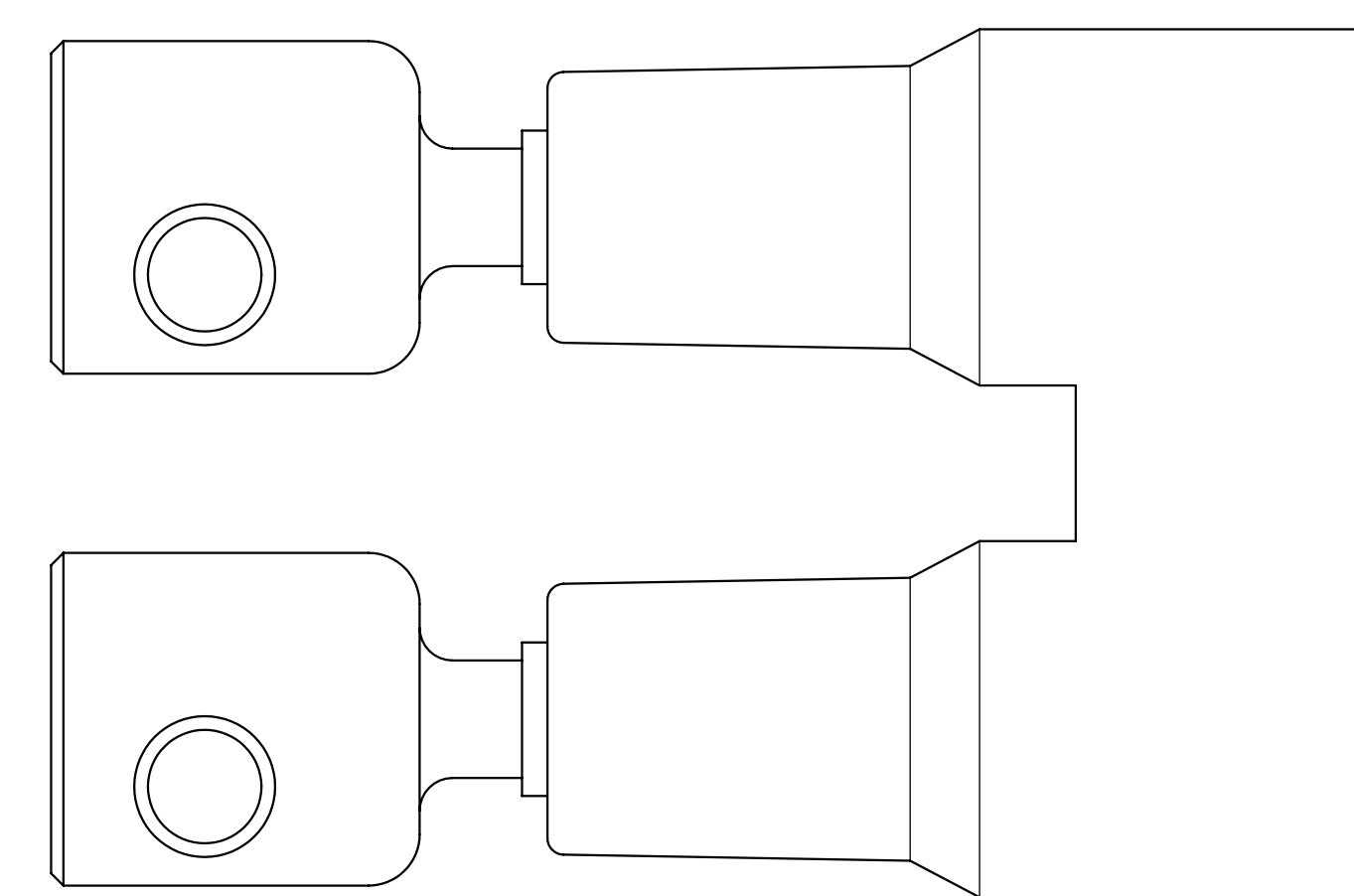

LOAD →

4.7" (118mm)

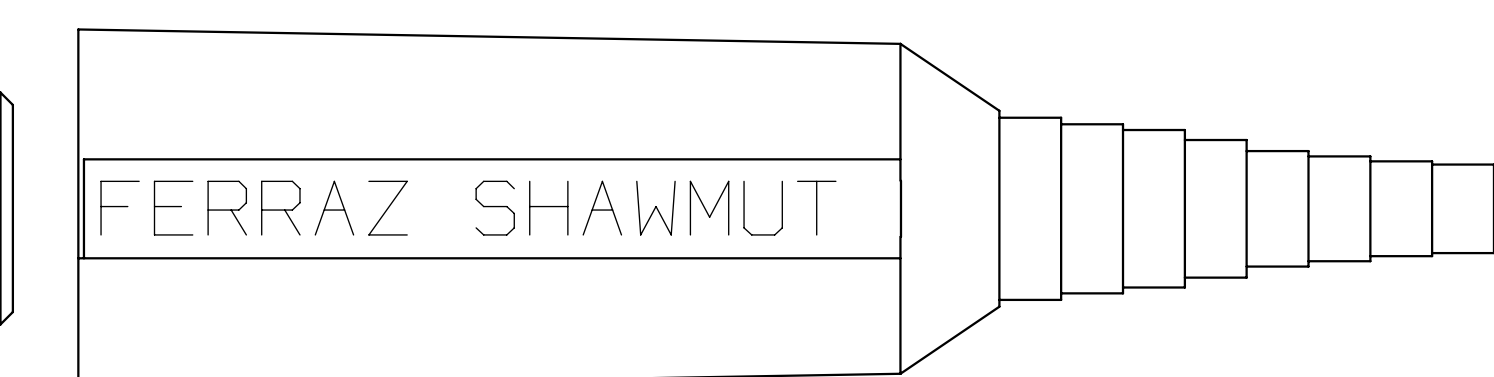

(FSB1 BOOT)

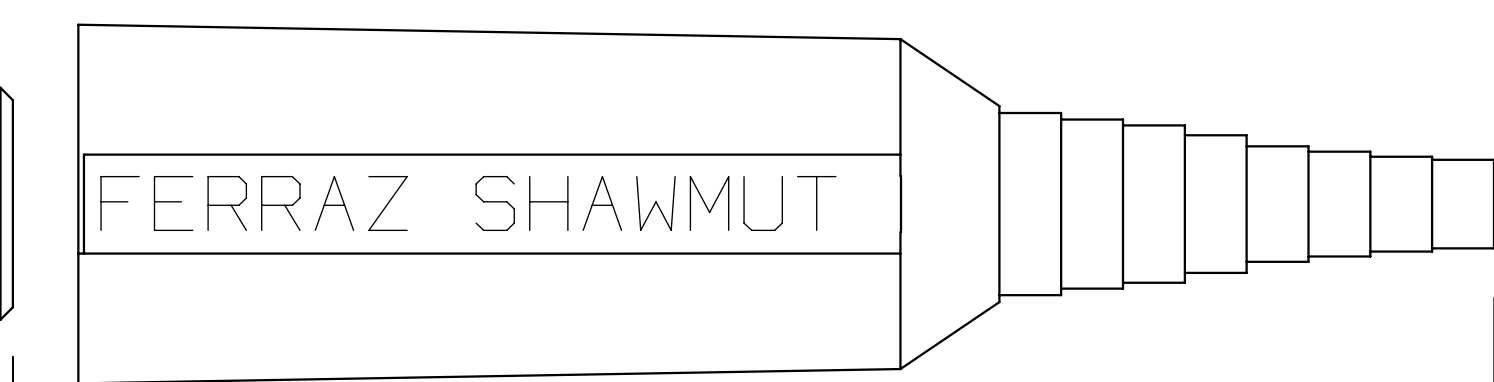

6.3" (160mm) ASSEMBLED LENGTH

8.7" (221mm) ASSEMBLED LENGTH

P/N	AMPERE RATING	RMS SYM RATING	CONN TYPE	TORQUE (LBS-IN)	WIRE			UL		CSA	
					WIRE RANGE	°C	TYPE	FILE NO.	GUIDE NO.	FILE NO.	CLASS
FEX-81-91-BA	30	100,000	81-Cu SINGLE SET SCREW	50 35 25 20	{1} #2-3 SOL/STR {1} #4-6 SOL/STR {1} #8 SOL/STR {1} #10-12 SOL/STR	75	Cu	E52283	IZLT2	32169	6225
			91-Cu DOUBLE SET SCREW	50 35 25 20	{1} #2-3 SOL/STR {1} #4-6 SOL/STR {1} #8 SOL/STR {1} #10-12 SOL/STR						



MERSEN USA NEWBURYPORT-MA, LLC  
374 MERRIMAC STREET  
NEWBURYPORT, MA 01950

FUSE HOLDER, 600V-30A,  
2 POLE, IN-LINE,  
MIDGET  
BREAKAWAY CONFIGURATION

OUTLINE DIMENSIONS  
NOT TO BE USED FOR PRODUCTION

700720

PRODUCT MANAGER  
SIGN:  
DATE:

DESIGN ENGINEER  
SIGN:  
DATE: