

M100-160xS Fused

M100-160xS Fused

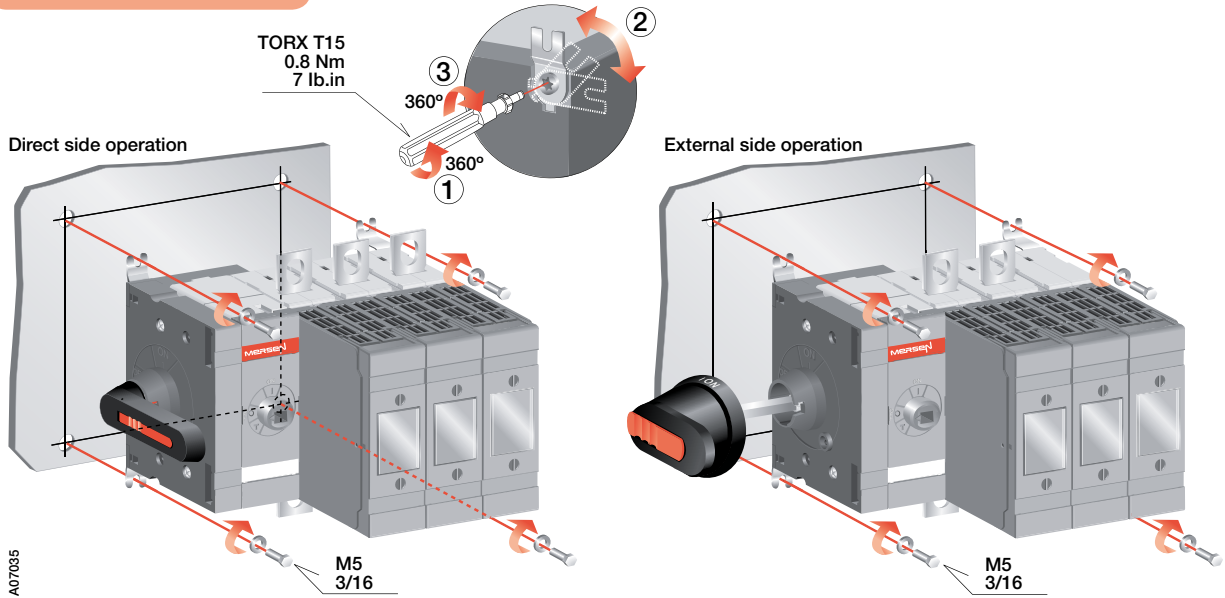

Dimensions for DIN, BS and NFC fuse types

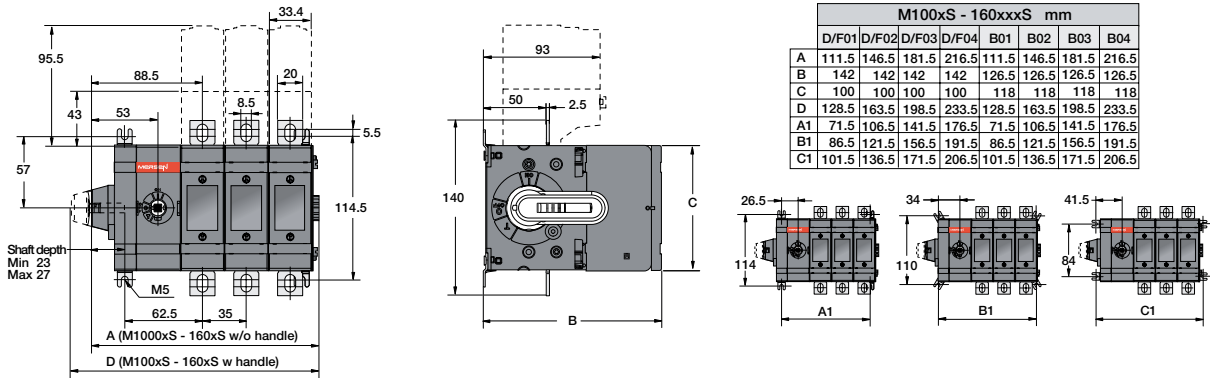

Dimensions for Class J fuse types

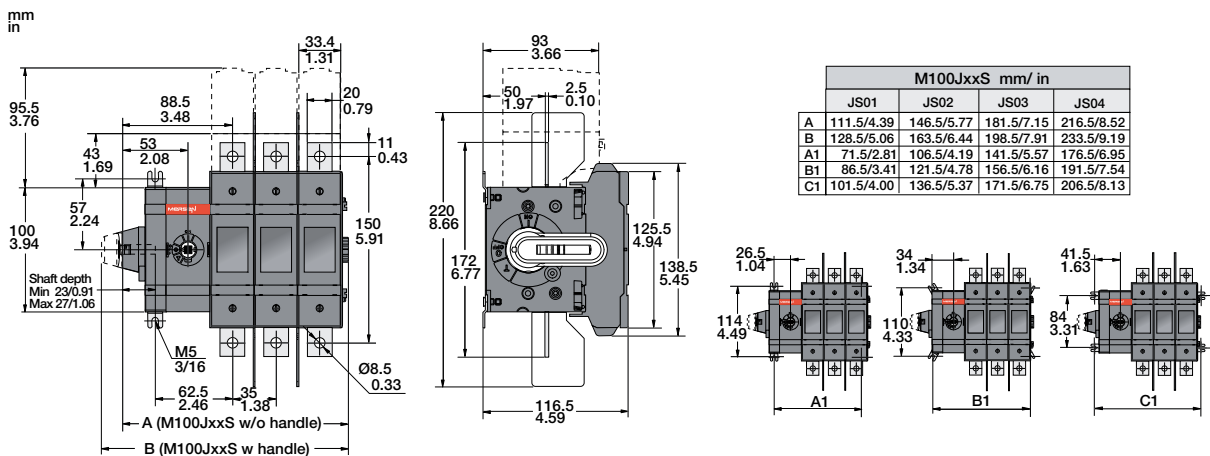

M100-160xS Fused

Label

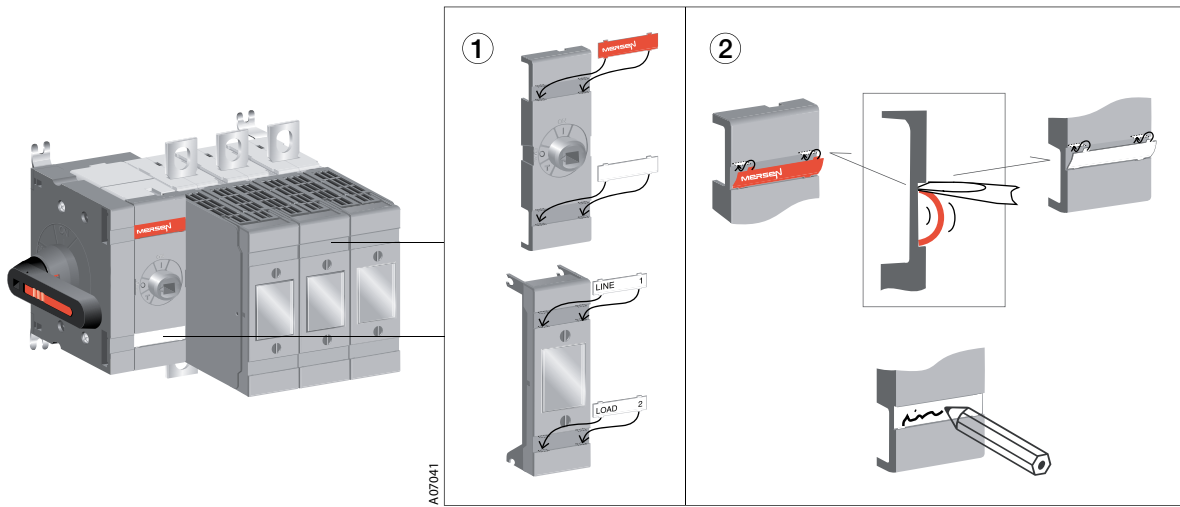

Fuse links

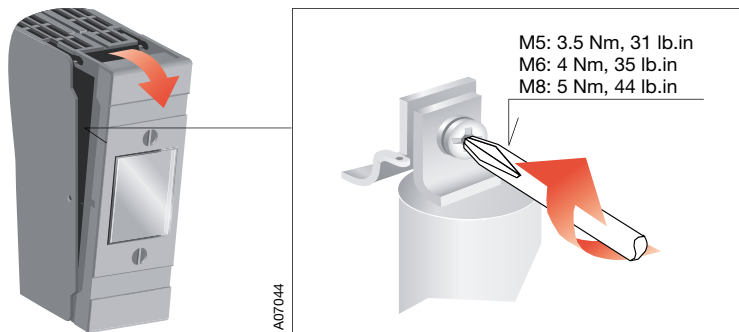

Lugs

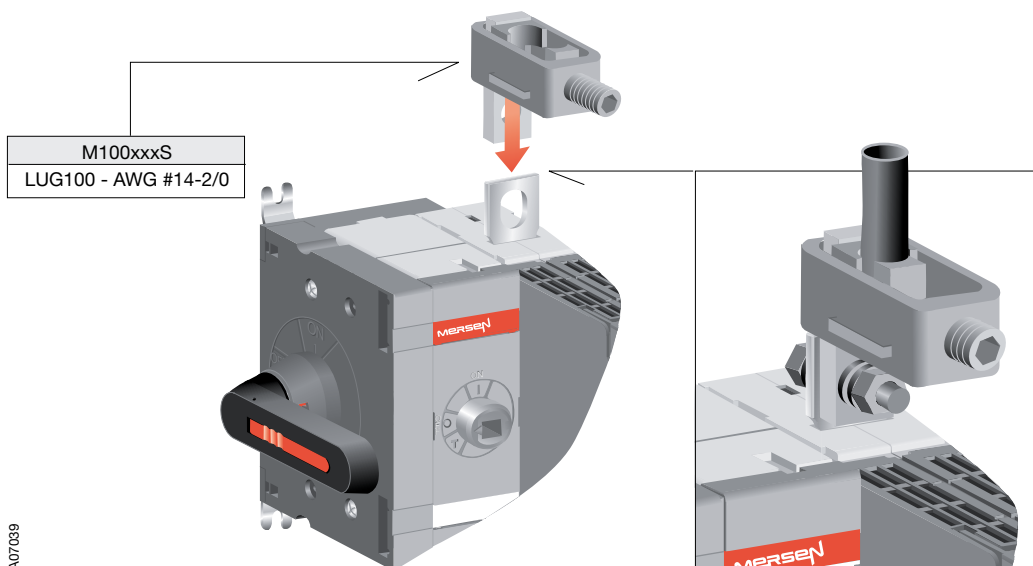

M100-160xS Fused

TSFxxx

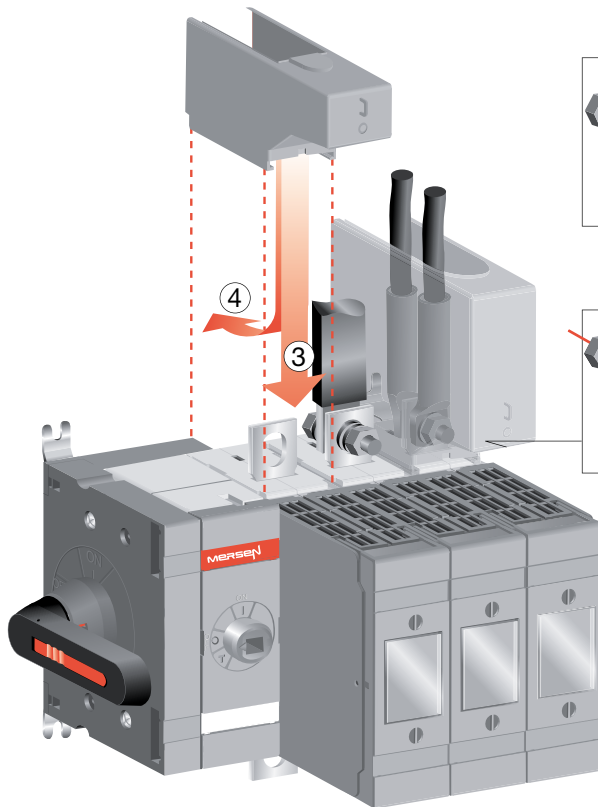
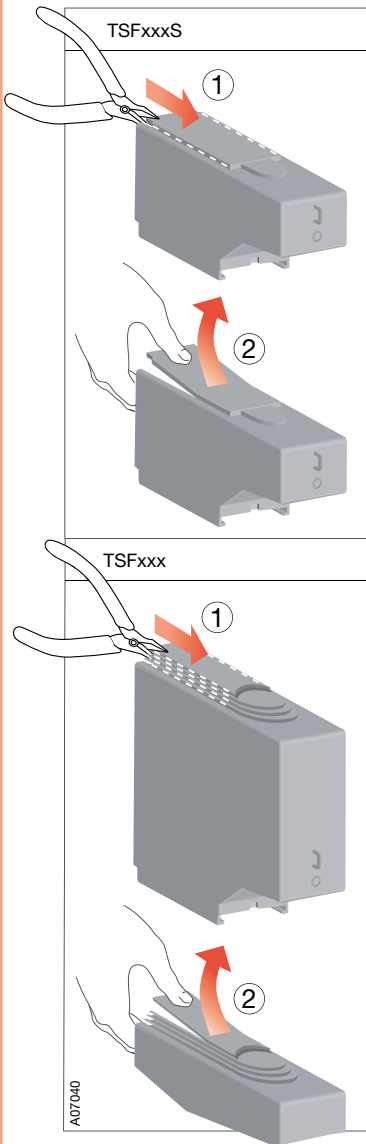

M8 15...22 Nm 133-195 lb.in

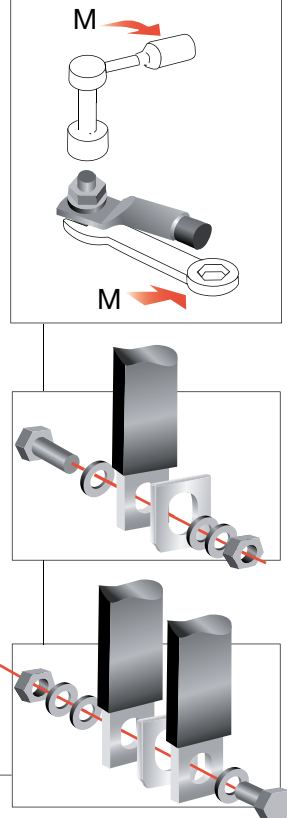

Clearances per UL98

Minimum enclosure size or equivalent volume

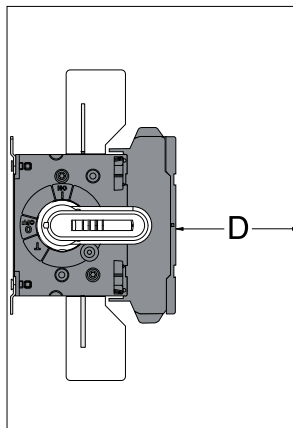
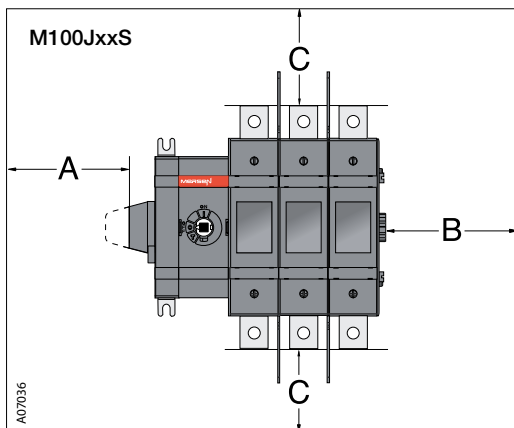

Height	Width	Depth
300 mm	350 mm	200 mm
12 in	14 in	8 in

A	0
B	13 mm 0.5 in
D	13 mm 0.5 in

Cable size		
AWG	C	
14-8	38 mm	1.5 in
6	51 mm	2 in
4-1	100 mm	4 in
1/0	125 mm	5 in
2/0	150 mm	6 in

M100-160xS Fused

Internally-mounted Auxiliary Contacts

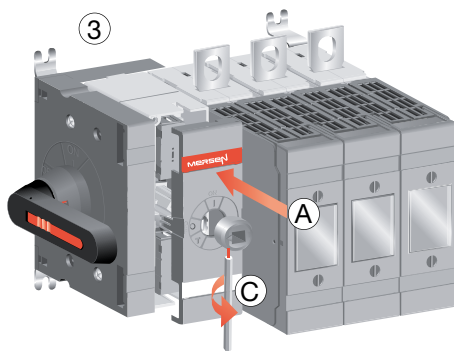
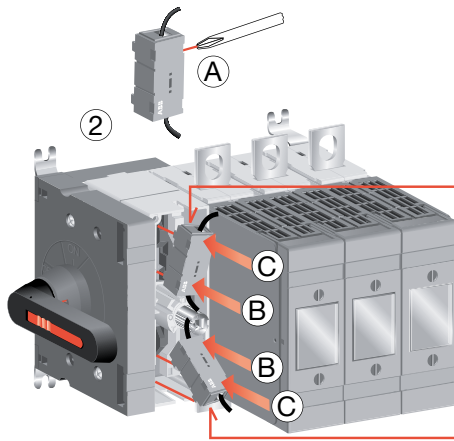
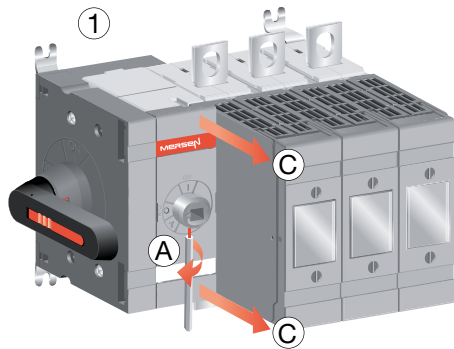

NO: OA1G10
NC: OA3G01

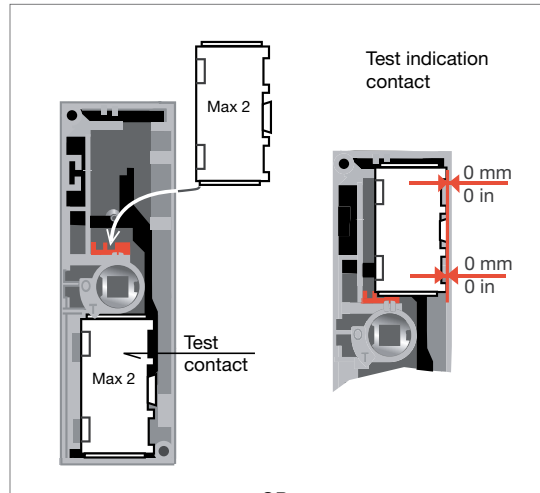

OR

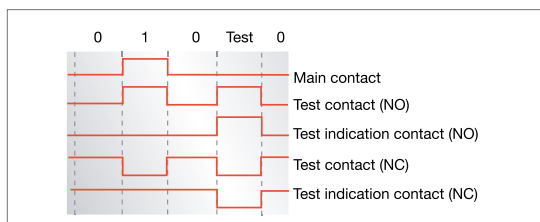
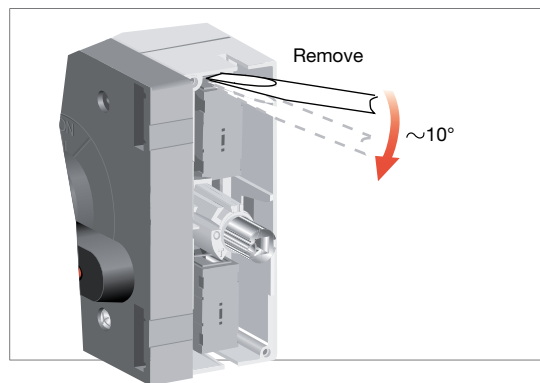
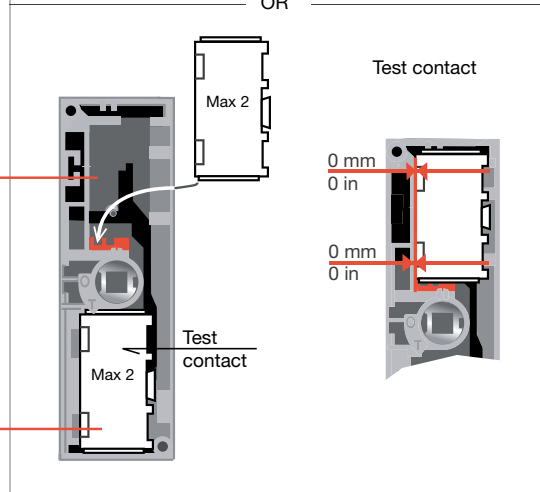

A07046

M100-160xS Fused

Externally-mounted Auxiliary Contacts

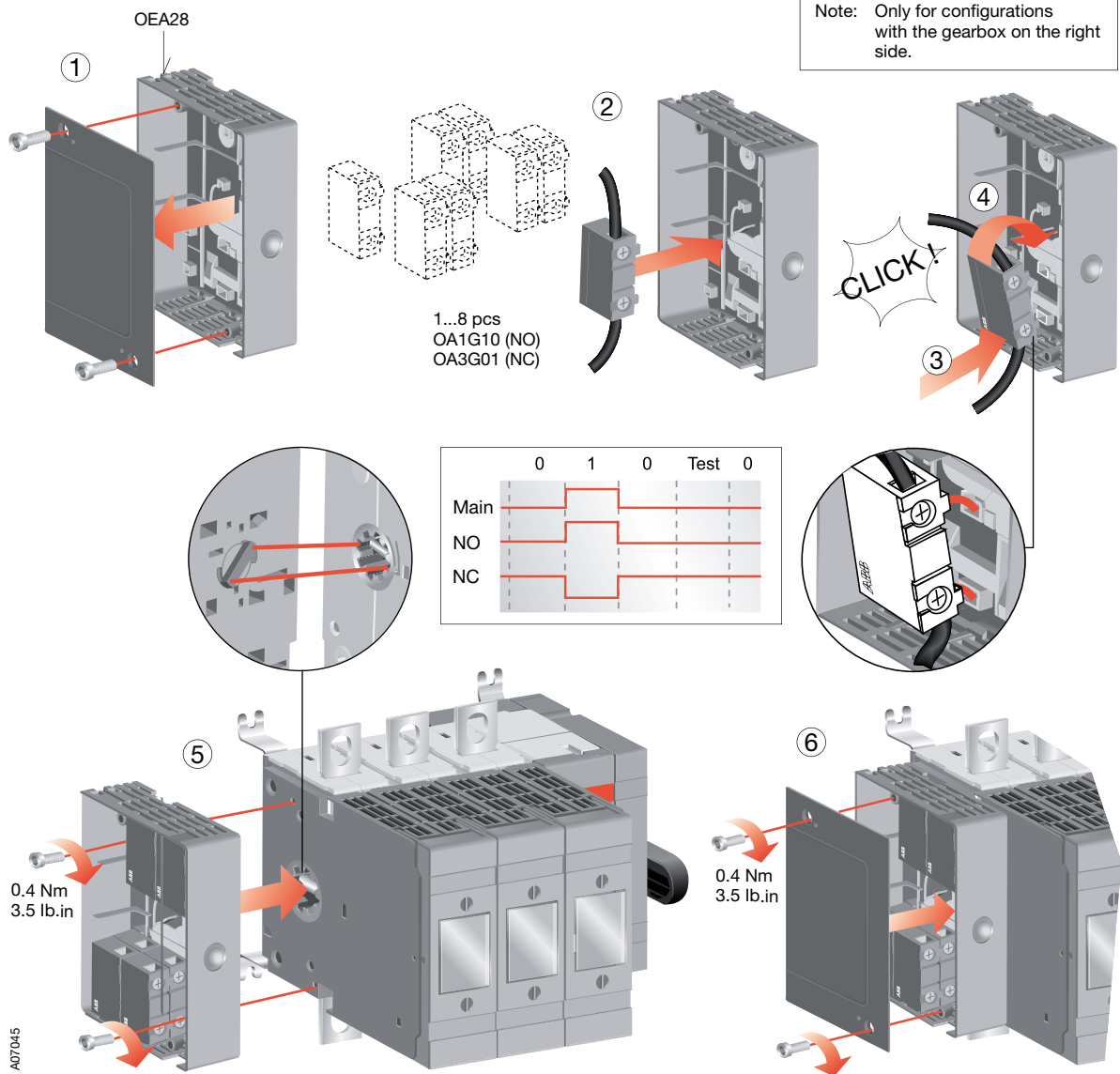

Neutral links

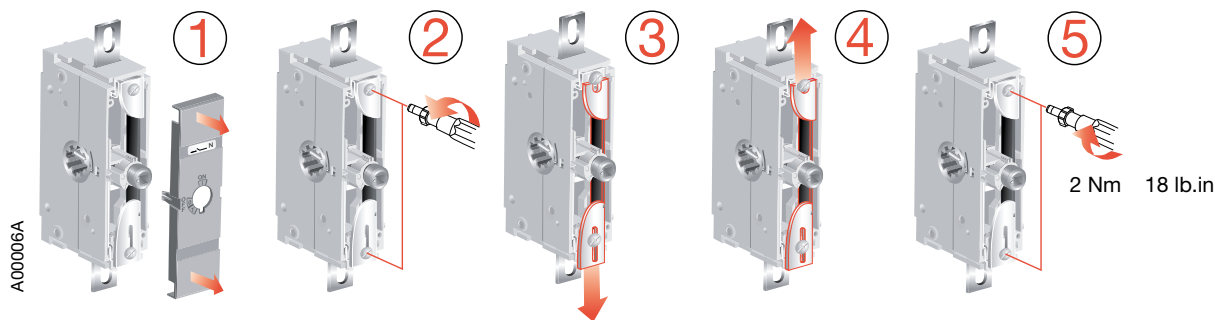

M100-160xS Fused

Neutral Links

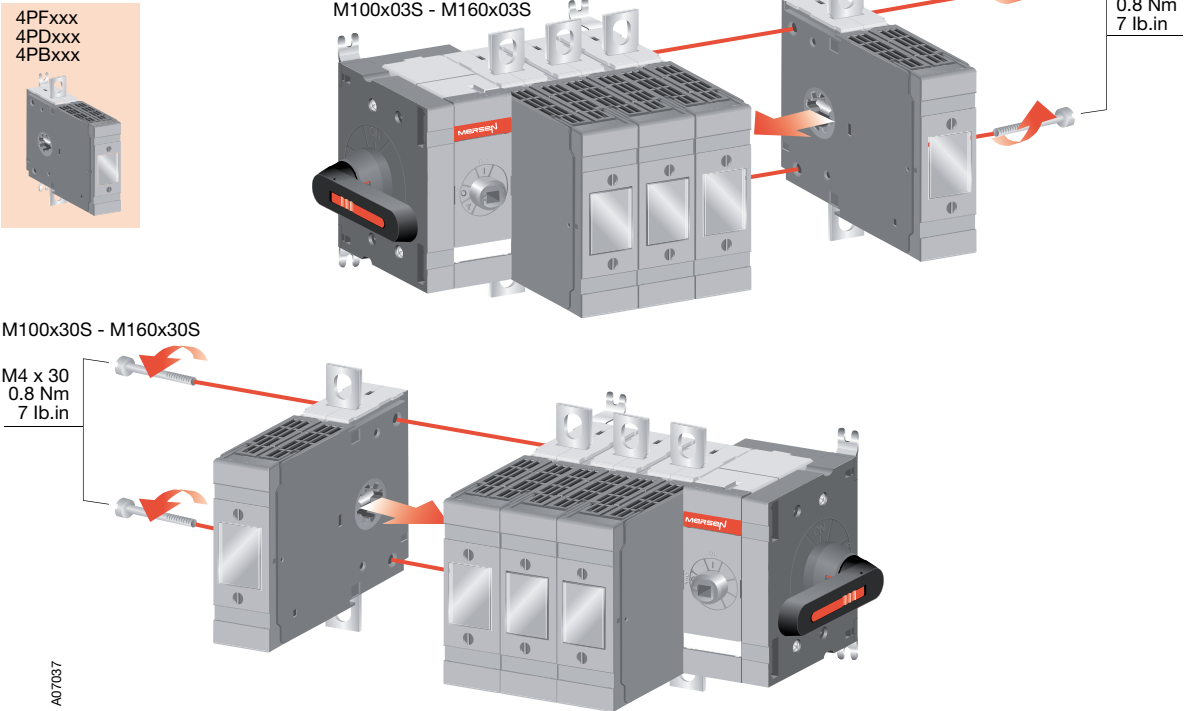

Handles

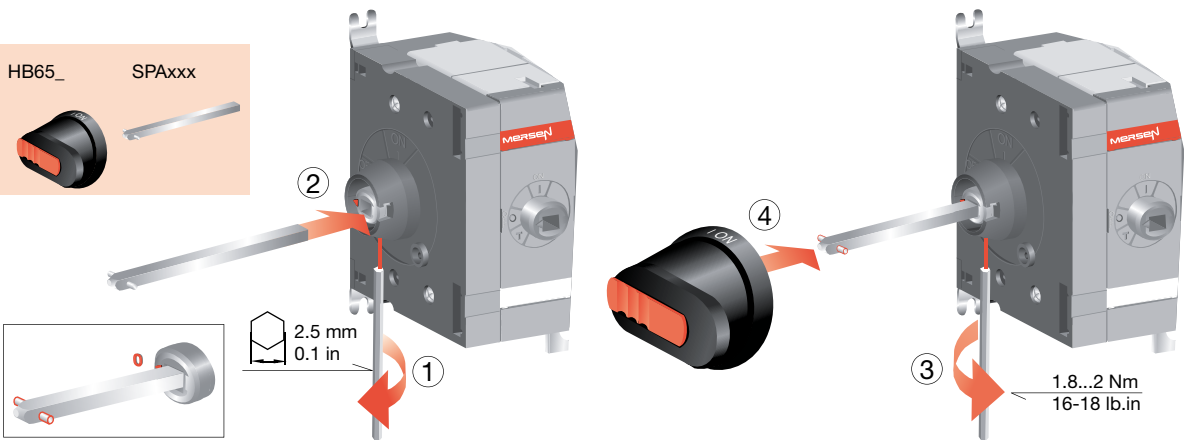

Direct side operation

Ø5...Ø6 mm

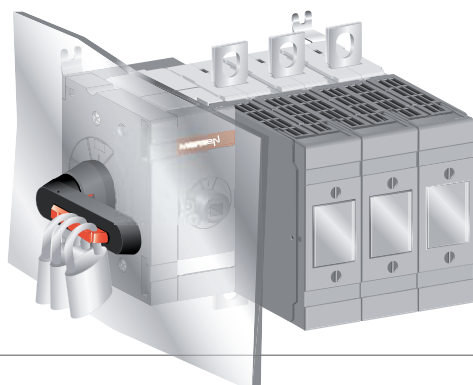

Note: Use protection against direct contact. For example:

External side operation

Ø5...Ø10 mm

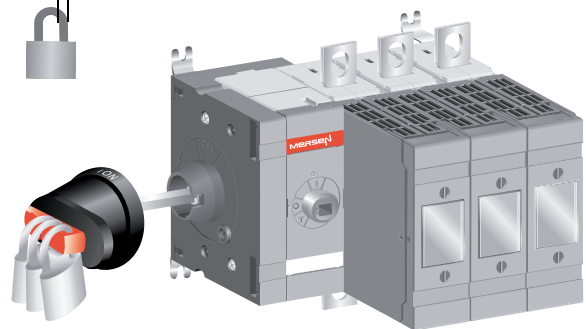

A07038

M100-160xS Fused

Fuse Monitor

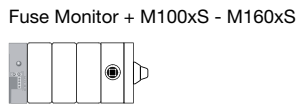
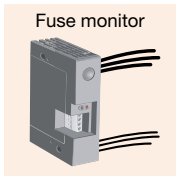

Note: Only for configurations with the gearbox on the right side.

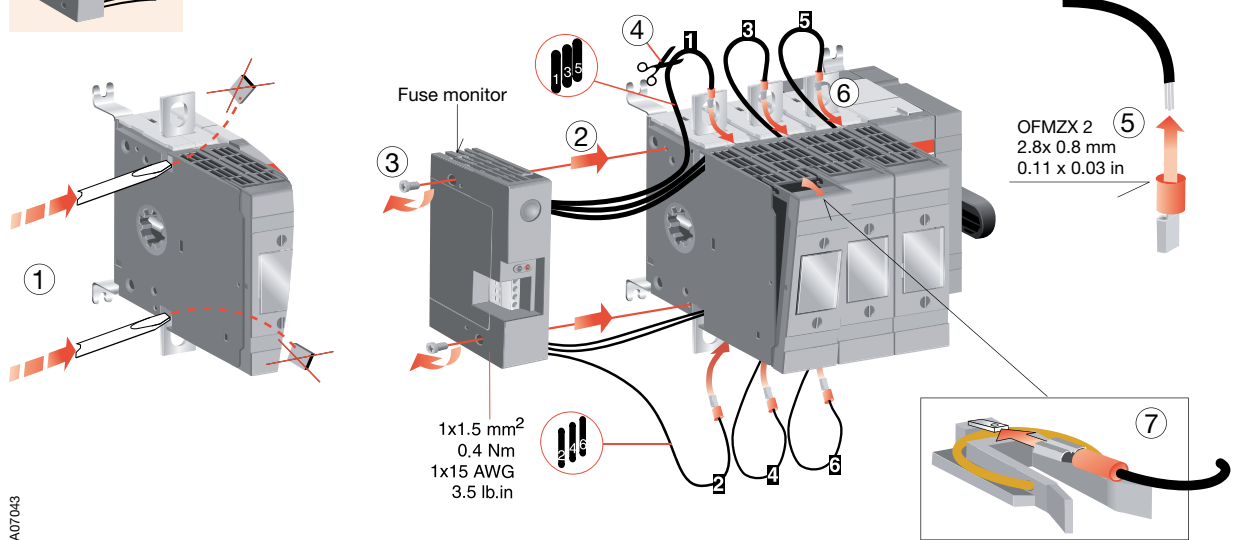

Blown Fuse Indicators

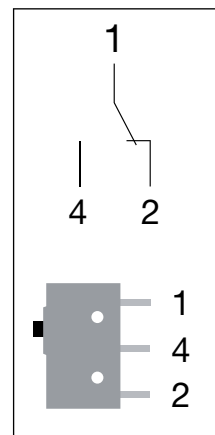
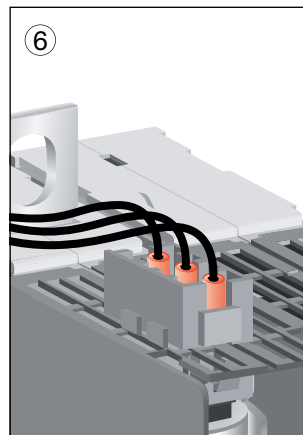
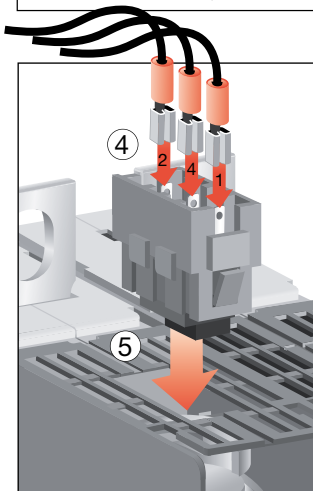
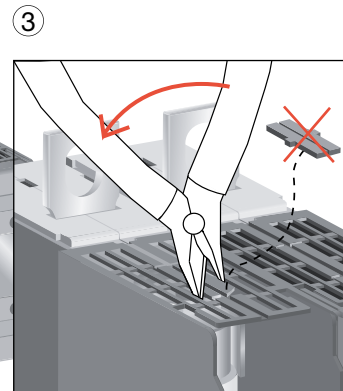
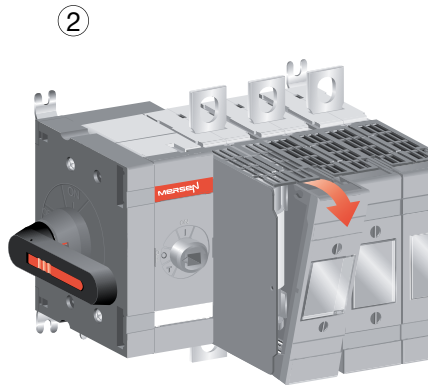
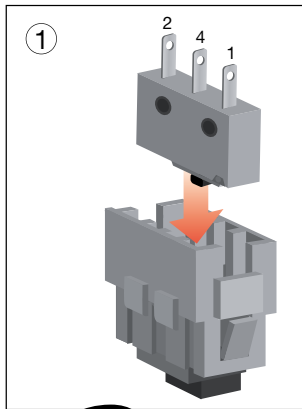

A04277

M100-160xS Fused

