

Abmessungen

NEOZED-Sicherungssystem

INNOZED-Sicherungssockel

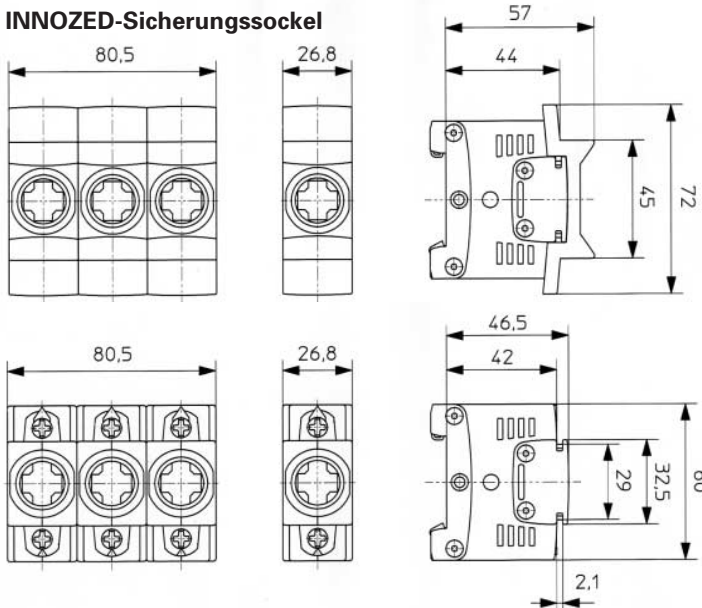

NEOZED-Sicherungssockel

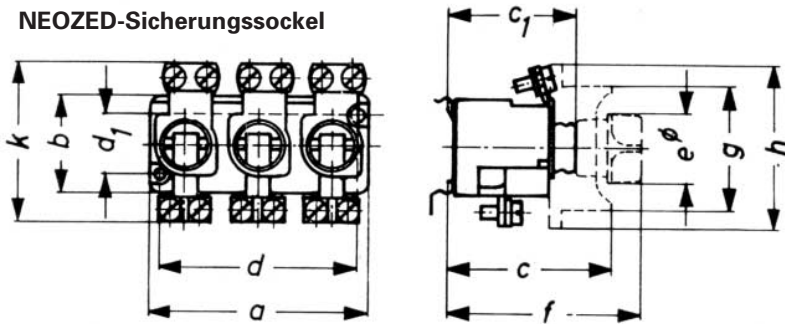

Maße in mm

Referenz-Nr.	a	b	c	c1	d	d1	eØ	f	g	h	k
1720.1	26	36	-	39,5	20	22	25,5	64	34Ø	-	50,5
1721.2/4	26	36	-	39,5	20	22	25,5	64	34Ø	-	57,5
1722.4	44	50	-	44	32	32	40	74	52Ø	-	86
1730.1	81	36	-	39,5	74	22	25,5	64	-	-	50,5
1731.2/4	81	36	-	39,5	74	22	25,5	64	-	-	57,5
1730.12	81	36	55	39,5	74	22	25,5	64	45	71	50,5
1731.22/42	81	36	55	39,5	74	22	25,5	64	45	71	57,5
1720.15	26	36	-	41,5	20	22	25,5	66	34Ø	-	50,5
1721.25/45	26	36	-	41,5	20	22	25,5	66	34Ø	-	57,5
1722.45	44	50	-	46	32	32	40	76	52Ø	-	86
1720.17	27	36	57	41,5	20	22	25,5	66	45	71	50,5
1721.27/47	27	36	57	41,5	20	22	25,5	66	45	71	57,5
1722.47	44	50	54,5	46	32	32	40	76	45	71	86
1730.15	81	36	-	41,5	74	22	25,5	66	-	-	50,5
1731.25/45	81	36	-	41,5	74	22	25,5	66	-	-	57,5
1730.17	81	36	57	41,5	74	22	25,5	66	45	71	50,5
1731.27/47	81	36	57	41,5	74	22	25,5	66	45	71	57,5

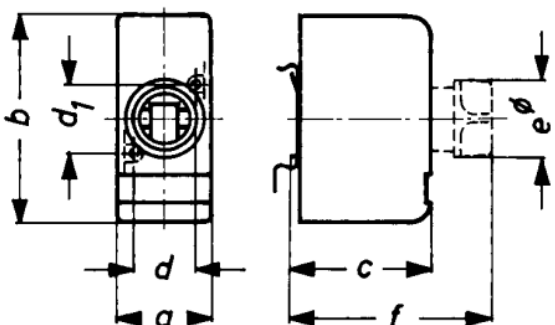

Referenz-Nr.	a	b	c	d	d1	eØ	f
1720.13	31	70	44,5	20	22	25,5	64
1721.23/1721.43	31	70	44,5	20	22	25,5	64
1722.43	50	105	48	32	32	40	74
1720.18	31	70	46,5	20	22	25,5	66
1721.28/1721.48	31	70	46,5	20	22	25,5	66
1722.48	50	105	50	32	32	40	76

Maßzeichnungen

NEOZED
Schraubkappen

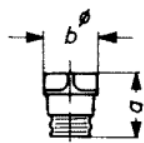

Referenz-Nr.	a	b
1714.	29,5	23
1715.	29,5	23
1710.	31	25
1711.	31	25
1712.	37	40

NEOZED
Hülsenpasseinsätze

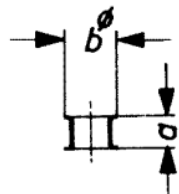

Referenz-Nr.	a	b
1705.	10	12
1706.	10	16
1707.	10	27

NEOZED
Abdeckungen

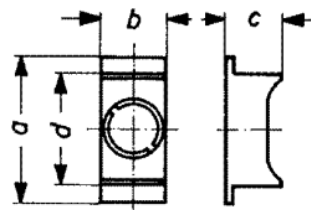

Referenz-Nr.	a	b	c
1718.008	60	26,8	23
1728.7	71	26,8	23
1728.	60	44	18
1732.7	71	81	23

NEOZED
Sicherungseinsätze

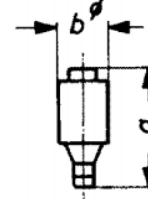

Referenz-Nr.	a	b
D01	36	11
D02	36	15
D03	43	22

LINOZED-Sicherungssockel

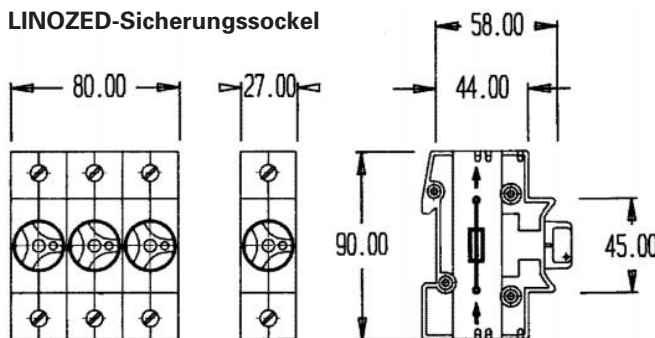

NEOZED-Reiter-Sicherungssockel
mit Schellenbefestigung, ~400V

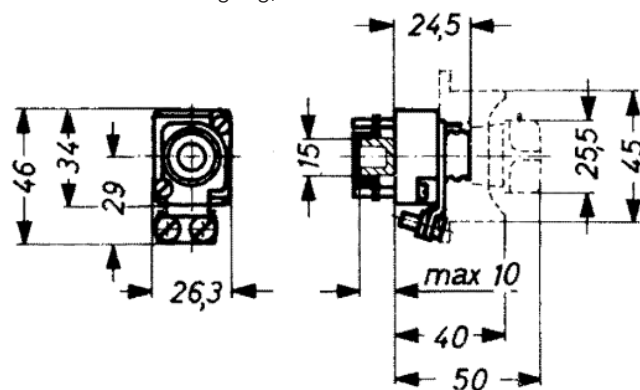

NEOZED-Reiter-Sicherungssockel
mit Schnappbefestigung, ~400V

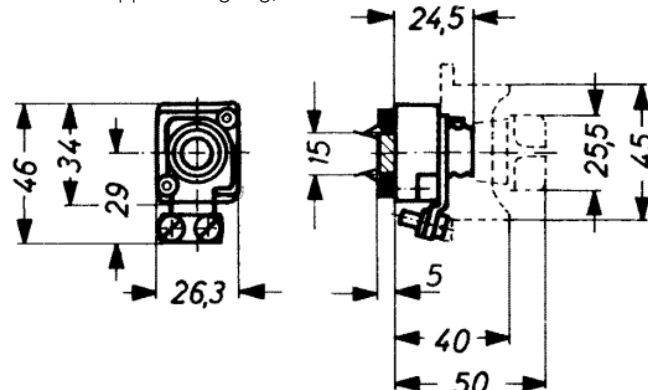

NEOZED-Reihen-Sicherungssockel

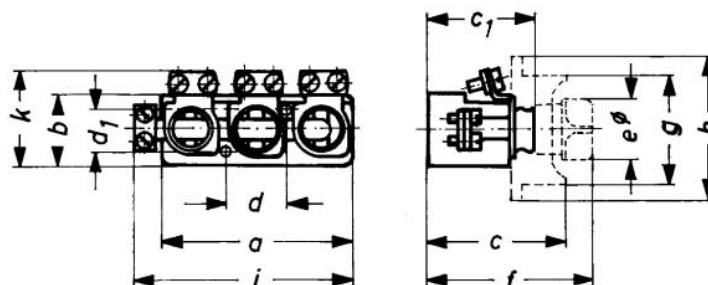

Maße in mm

Referenz-Nr.	a	b	c	c1	d	d1	e	f	g	h	i	k
1737.12	80,5	30	55	39,5	22	20	25,5	64	45	71	88,5	36,5
1738.22	80,5	30	55	39,5	22	20	25,5	64	45	71	91,5	44,5
1737.17	80,5	30	57	41,5	22	20	25,5	66	45	71	88,5	36,5
1737.27	80,5	30	57	41,5	22	20	25,5	66	45	71	91,5	44,5